

Panel



C = Cup centerpoint

20.5	21.5	22.5	23.5	24.5	25.5
13/16"	27/32"	7/8"	15/16"	31/32"	1"
3	4	5	6	7	8

B = Bore distance

1. Drill 35mm hole in door at required height and hinge cup centre point.
2. Screw on or insert hinge.
3. Mark centre height of hinge arm on side frame.
4. Position mounting plate 37mm from edge of side frame.

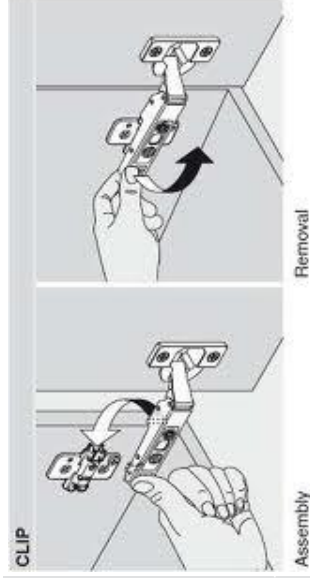
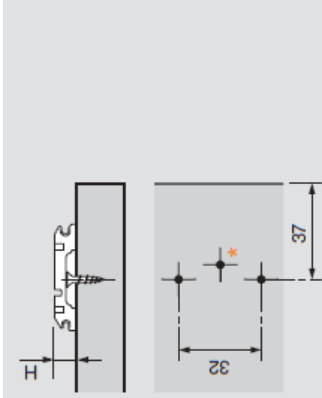
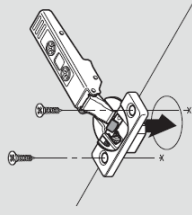
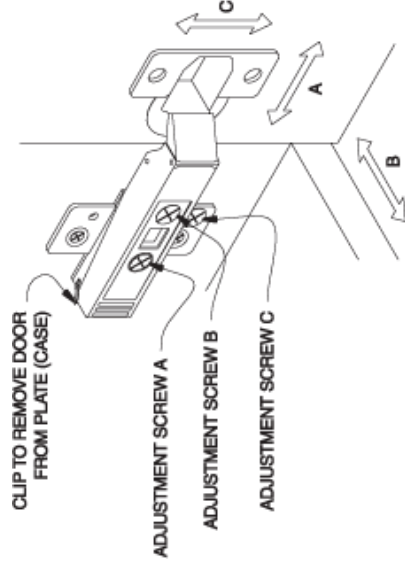

Tool-free attachment with INSERTA expanding Ø8 mm dowels

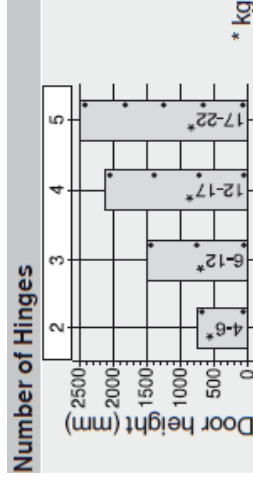
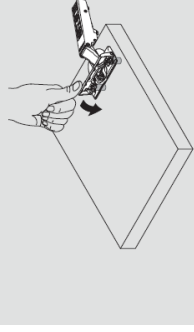

The number of hinges depends on the front weight.

To achieve good stability, distances between hinges should be as large as possible.

Indications on weight and height apply to a standard door width of 600 mm.