

BLUM 95 degree Inset blind corner hinge. CLIP TOP BLUMOTION

Back of door is flush with stationary panel

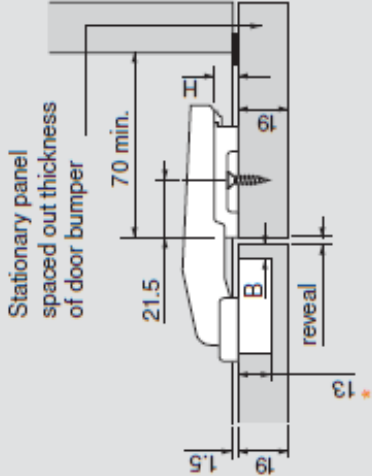

Hinge cup centerpoint

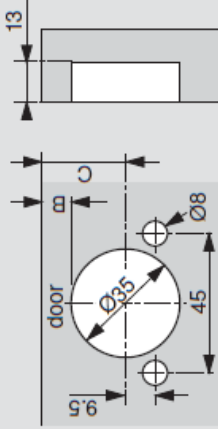

C = Cup centerpoint

20.5	21.5	22.5	23.5	24.5	25.5
13/16"	27/32"	7/8"	15/16"	31/32"	1"
3	4	5	6	7	8
B = Bore distance					

1. Drill 35mm hole in door at required height and hinge cup centre point.
2. Screw on or insert hinge.
3. Mark centre height of hinge arm on side frame.
4. Position mounting plate 21.5mm from edge of side frame.

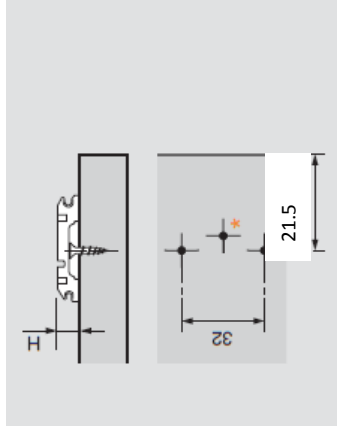

Side adjustment

Rotate front screw to increase or decrease door overlay (±2 mm).

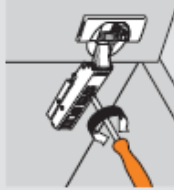
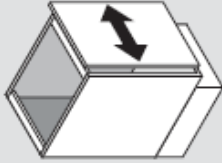

Height adjustment

Pivotate cam screw on mounting plate to adjust door position (±2 mm).

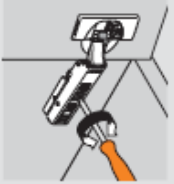
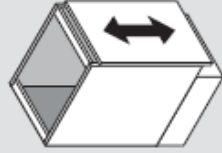

On non-cam mounting plates, loosen screws, adjust door and retighten screws.

Depth adjustment

Rotate rear spiral tech cam screw to adjust door gap (+3 mm, -2 mm).



Number of Hinges

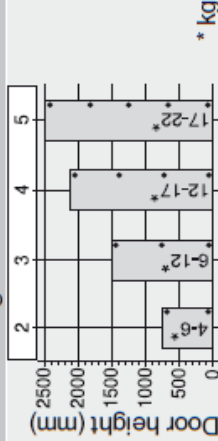

The number of hinges depends on the front weight.

To achieve good stability, distances between hinges should be as large as possible.

Indications on weight and height apply to a standard door width of 600 mm.

* kg

Screw-on
Use #6 wood screws

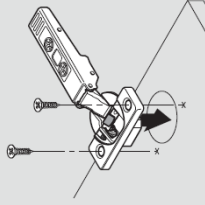

INSERTA

Tool-free attachment with INSERTA expanding Ø8 mm dowels

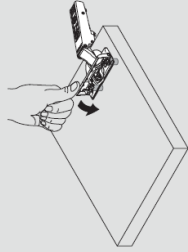

Deactivation switch on hinge cup

For small or light doors, the BLUMOTION can be deactivated on one of the hinges.

